



Giving Continuous IV Heart Medication with the Sapphire[®] Pump

Medication:

What do I do when I get the medication from HomeMed?

- **Always check the prescription and label** for final instructions.
 - check your name
 - medication name and dose
 - how frequently the medication should be given
- **If the information does not match, contact HomeMed immediately at (800) 862-2731.**
- Check the bags and syringes for expired dates, color changes, leaks and floating materials. If noted, do not use the item and notify HomeMed.
- Check medication labels for storage instructions.
- If your medication needs to be refrigerated, bring to room temperature by removing dose several hours before giving it.

Key points to remember about your continuous heart medication:

- **Do not flush the lumen continuously infusing the medication without clinician permission.** Flush any unused lumen once a day with heparin to maintain patency.
- Alternate pumps with each tubing change.
- Upon leaving home, always take back-up pump, charger, supplies and an extra medication bag.
- Notify HomeMed immediately if you need to use a backup medication bag.
- In the event of an ER visit or hospital admission, bring both Sapphire pumps and 2 extra bags of medication and supplies.

What do I need to do to prevent infection?

- Work at a comfortable pace. The risk of contamination increases if you rush.
- Always wash your hands for 15 seconds with soap or use an instant hand sanitizer before any procedure. Do not touch anything dirty, such as your clothes, glasses or skin after washing your hands. If you do, rewash them.
- If you wish to use an instant hand sanitizer, use one that contains alcohol in concentrations between 60-90%. Do not use an instant hand sanitizer if your hands are visibly soiled or you have a C. difficile infection.

What supplies do I need?

(1) Prefilled IV medication bag

(1) Sapphire® IV tubing (remove from package)

(1) filter extension set (remove from package)

(1) Back check valve (open package)

(1) Alcohol pad

Sapphire® pump

Household disinfectant or alcohol

Soap

Paper towel

How do I prepare for the procedure?

1. Place a trash can next to your work area.
2. Clean your work surface or laminate mat with a household disinfectant. Let the area air dry.
3. **Wash your hands** as follows:
 - a. Wet your hands and wrists under running water.
 - b. Scrub vigorously with soap for 15 seconds.
 - c. Work lather between fingers, under nails, over the palms and back of hands.
 - d. Rinse hands well by keeping your hands up with fingers pointing up towards the ceiling so that the dirty water runs toward your elbows.
 - e. Dry your hands with a clean paper towel from tips of fingers down.
 - f. Turn off the faucet with the paper towel.
4. Gather your supplies and place on your work area.
5. **Wash your hands again.**



How do I prepare the tubing?

1. **Turn the pump on** by pressing the [ON/OFF] hard key in lower right corner.
2. Press **[PreSet Programs]** on the pump screen (see figure 1).
3. Select desired preset program on screen (review the pump program with the medication label).
4. Press **[OK]**.



Figure 1

5. Attach the filtered extension set to the Sapphire® pump tubing as follows:
- Remove end cap from the Sapphire® pump tubing
 - Remove end cap from the shorter end of the filtered extension set tubing and connect to the open end of the Sapphire® tubing.
 - Twist cuff from Sapphire® tubing onto the filtered extension set.

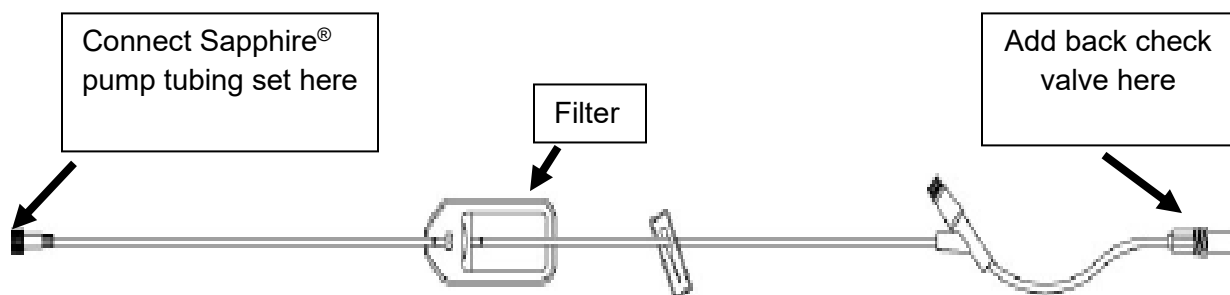

6. Attach back check valve to filtered extension set tubing as follows:

- Remove back check valve from package holding clear center piece.
- Take cap off the end of the filtered extension tubing.
- Remove short, round cap on the end of back check valve and connect to open end of the filtered extension tubing.
- Twist cuff from filtered extension tubing onto the back check valve.

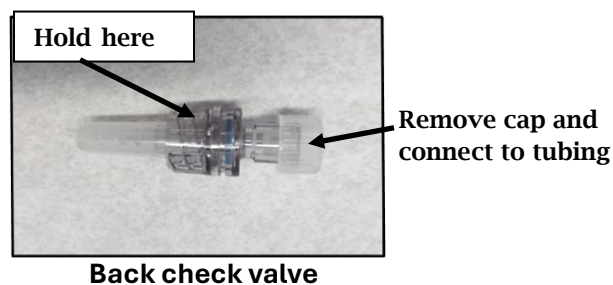

7. Open the safety door on the Sapphire® pump. Using your thumb, press safety door outwards.

8. Insert the IV tubing cassette into the pump by placing the saddle on the round metal anchor (Figure 2) and clipping the upper end of the cassette into the metal lock (Figure 3).



Figure 2



Figure 3

9. Close the safety door and ensure that it clicks upon closure.
10. Spike the IV bag with the pump tubing as follows:
 - a. Remove the tab on the IV bag.
 - b. Keeping the spike sterile, remove the spike cover from the IV tubing. **Do not touch the spike.**
 - c. Hold the port of the IV bag straight and insert the spike by pushing and twisting at the same time.
11. Prime (fill with fluid) and remove the air from the IV tubing as follows:
 - a. Loosen the cap, being careful not to remove it, at the end of the back check valve.

- b. Press **[PRIME]** in the lower left corner of the screen (Figure 4). The pump will prompt you to be sure that the tubing is **NOT** connected to the patient's catheter (Figure 5).

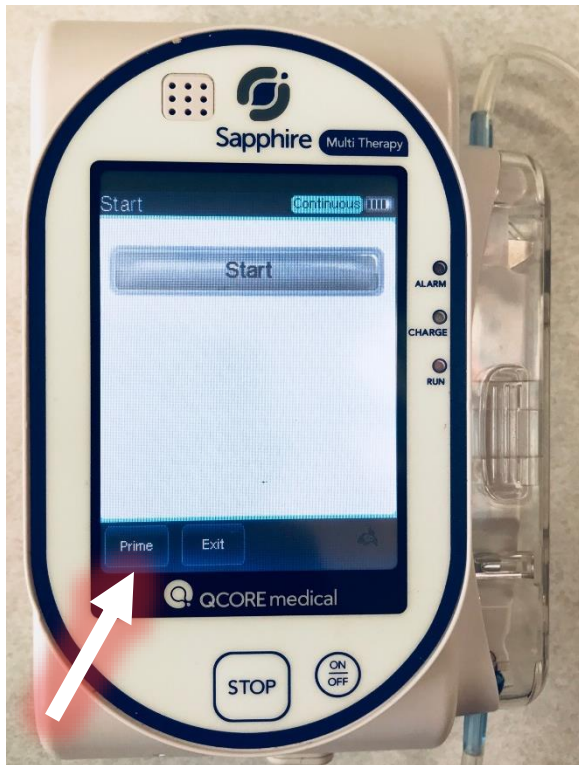

Figure 4



Figure 5

- c. Press **[Prime]** again and the pump will begin to prime (fill the tubing) with the IV solution. Hold the filter with the pointed end in an upward direction until the tubing is fully filled with fluid.
- d. Once the pump has stopped priming, check to be sure that the IV set is filled with fluid and no air remains. If not, repeat the priming steps.
12. Once you stop priming, the pump screen will prompt you to “connect set to patient after prime.” Press **[OK]**.

How do I give the medication?

1. Check your catheter cap to make sure it is on securely. Always hold your catheter cap while connecting/disconnecting to prevent accidental removal.
2. **Vigorously** scrub the end of the cap on your catheter with an alcohol pad for 15 seconds.
3. Remove and discard the protective cap from the end of IV tubing.
4. Push and twist the end of IV tubing into your catheter cap to the right until secure.
5. Make sure all clamps on your catheter and IV tubing are open.
6. Press **[Start]** on the screen to begin the infusion.
7. Press **[Lock]** then **[Patient lockout]** on the screen.
 - Screen will darken after 30 seconds.
 - The run light will continue to flash green.
 - To “wake up” the screen, press the on/off button **once**, and after a brief pause the screen will light up.
8. Place the IV bag and pump into the backpack/fanny pack.



Valved IV
catheter
cap

How do I change the IV bag and tubing?

Change your IV tubing every 3 days or *as directed* by your nurse or pharmacist. Labels will be provided to help you keep track.

1. Clean your work surface or laminate mat with household disinfectant. Let the area air dry.
2. Wash your hands.
3. **Using your second/backup pump**, follow steps 1-12 under “**How do I prepare the tubing?**” (See pages 3-6).
4. Open the backpack/fanny pack and place the empty IV bag and pump on the work area.

5. Screen will display “Infusion Complete”. Press **[Mute]** then **[OK]** on screen.
6. Press **[Press to unlock patient]** on screen.
7. Keypad appears. Enter password “8880”.
8. Press **[OK]** on screen.
9. Turn pump off using the *hard* **[ON/OFF]** key on the pump.
10. Screen will display “Press OFF to turn off the pump”.
Press **[OFF]** on the screen.
11. Wash your hands.
12. Disconnect the completed infusion IV tubing from your catheter.
13. Connect the new IV tubing by following steps 1-7 under “**How do I give the medication?**” (see page 7).
14. Place the new IV bag and the pump that is ON into the backpack/fanny pack.
15. Remove the old tubing cassette from the pump that is OFF by opening the safety door and then raising the metal lock that secures it to the pump (Figure 6).
16. Throw away empty bag and tubing.
17. Charge back-up pump.

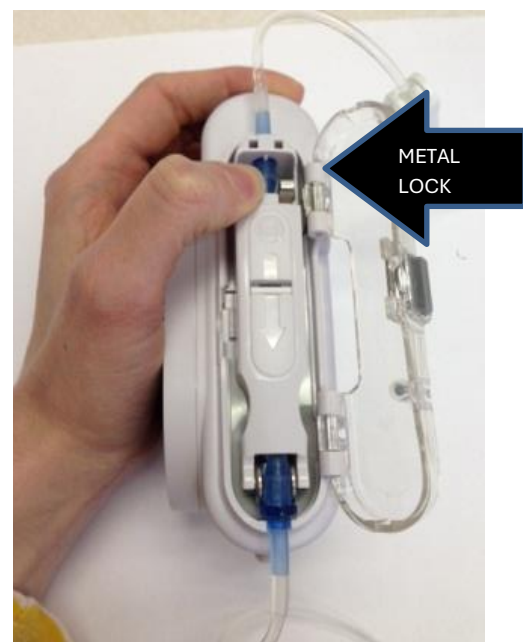

Figure 6

What do I do if the pump alarms?

When an alarm sounds, the pump will immediately provide a message with the error and suggested solution.

1. Press **[Mute]**.
2. Follow the suggested solutions and then press **[OK]**.
3. Press **[Press to unlock patient]** on screen.
4. Keypad appears. Enter password “8880”.
5. Press **[OK]** on screen.
6. Press **[Request Continue]** then **[OK]** to restart the infusion.
7. Press **[Lock]** then **[Patient lockout]**.

- Contact HomeMed if you are unable to resolve the alarm.

What do I do if there is air in the IV tubing?

If you need to remove air from the IV tubing do the following:

1. Press **[Mute]** and then **[OK]** if the pump is alarming.
2. Press **[Press to unlock patient]** on screen.
3. Keypad appears. Enter password “**8880.**”
4. Press **[OK]** on screen.
5. **Disconnect the IV tubing from the patient** keeping the end of the tubing sterile. You will need to change the tubing if it is dropped or touches any unsterile object.
6. Press **[Prime]**. The pump screen will remind you to disconnect from the patient.
7. Press **[Prime]**. Once all the air is removed, press **[Finish Prime]** then **[OK]**.
8. **Vigorously** scrub the end of the cap on your catheter with an alcohol pad for 15 seconds.
9. Push end of IV tubing into your catheter cap to the right until secure.
10. Press **[Request Continue]** then **[OK]** to restart the infusion.
12. Press **[Lock]** then **[Patient lockout]**.

How do I care for the infusion pump?

- Do not place your pump in any fluids or cleaning solutions.
- Avoid dropping or hitting your pump. Always recheck the program if you drop or hit your pump.
- Never use sharp objects such as pens, pencils, fingernails or paper clips to clean your pump.
- If needed, clean your pump using an alcohol wipe or a soft cloth dampened with a mild soap and water.

- You may wash the backpack/fanny pack in your washing machine and dry under low heat in your dryer.
- **Never** use the pump in the presence of flammable or explosive vapors.
- **Avoid exposing pump to extreme temperatures.**
- **Always avoid sources of high intensity electromagnetic radiation such as x-ray machines.**

How do I charge the battery?

Charge your pump battery at least 4 hours every day. The pump can operate while it is being charged. To preserve battery life, charge the pump whenever possible.

Charge the battery as follows:

1. With the white arrows facing up, plug the plastic end of the power supply cord into the Sapphire® pump power socket. If you are supplied with a pump cradle, plug the cord into the bottom of the cradle.
 2. Plug the other end of the power supply cord into a wall outlet.
 3. On the front of the pump, verify that the Charge LED status indicator is ON (blinking yellow light). The yellow LED will remain lit when battery is fully charged.
 - An alarm is triggered when there are 30 minutes left until battery depletion.
 - If the “Battery Depletion” alarm sounds, immediately connect the pump to the wall outlet using the power supply cord.
- **Make sure your backup pump is fully charged and functional (by alternating use with tubing changes).**

In summary: These are the steps to follow when giving your continuous IV heart medication with the Sapphire® pump:

- ✓ Wash your hands
- ✓ Turn pump on and review program
- ✓ Attach the filtered extension set to the Sapphire® pump tubing
- ✓ Attach back check valve to filtered extension set tubing
- ✓ Place IV tubing into pump
- ✓ Spike bag
- ✓ Prime tubing with fluid
- ✓ Start infusion
- ✓ Change tubing and IV bag as directed by your nurse or pharmacist

What if I still have questions?

- Call HomeMed. Our 24-hour number is 800-862-2731.
 - Please identify yourself to the hospital operator as a **HomeMed** patient.
- For on-line video and resources, please visit:
 - **Link:** <https://homecare.med.umich.edu/HomeMed/Patient-Resources>
 - **QR code:**



Disclaimer: This document contains information and/or instructional materials developed by Michigan Medicine for the typical patient with your condition. It may include links to online content that was not created by Michigan Medicine and for which Michigan Medicine does not assume responsibility. It does not replace medical advice from your health care provider because your experience may differ from that of the typical patient. Talk to your health care provider if you have any questions about this document, your condition or your treatment plan.

Patient Education by [Michigan Medicine](#) is licensed under a [Creative Commons Attribution-NonCommercial-ShareAlike 4.0 International Public License](#). Last Revised 1/2026